

# PFEIFER INDUSTRIES, LLC.

2180 Corporate Lane, Suite 104 ~ Naperville, IL 60563 USA

Phone (630) 596-9000 Fax (630) 596-9002

E-mail: info@pfeiferindustries.com Web site: www.pfeiferindustries.com

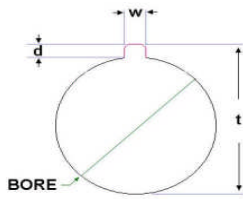

## DIN 7154, H7 Metric Bore and DIN 6885, Js9 Square Keyway Tolerances

		Bore (inches)	Keyway Width (w)	Keyway Height (d) Reference	(t) - DIM
8mm	Minimum	<u>0.315</u>	2mm	1mm	<u>0.354</u>
	Maximum	0.316			
9mm	Minimum	<u>0.354</u>	3mm	1.4mm	<u>0.409</u>
	Maximum	0.355			
10mm	Minimum	<u>0.394</u>	3mm	1.4mm	<u>0.449</u>
	Maximum	0.394			
11mm	Minimum	<u>0.433</u>	4mm	1.8mm	<u>0.504</u>
	Maximum	0.434			
12mm	Minimum	<u>0.472</u>	4mm	1.8mm	<u>0.543</u>
	Maximum	0.473			
14mm	Minimum	<u>0.551</u>	5mm	2.3mm	<u>0.642</u>
	Maximum	0.552			
15mm	Minimum	<u>0.591</u>	5mm	2.3mm	<u>0.681</u>
	Maximum	0.591			
16mm	Minimum	<u>0.630</u>	5mm	2.3mm	<u>0.720</u>
	Maximum	0.631			
17mm	Minimum	<u>0.669</u>	5mm	2.3mm	<u>0.760</u>
	Maximum	0.670			
19mm	Minimum	<u>0.748</u>	6mm	2.8mm	<u>0.858</u>
	Maximum	0.749			
20mm	Minimum	<u>0.787</u>	6mm	2.8mm	<u>0.898</u>
	Maximum	0.788			
22mm	Minimum	<u>0.866</u>	6mm	2.8mm	<u>0.976</u>
	Maximum	0.867			
24mm	Minimum	<u>0.945</u>	8mm	3.3mm	<u>1.075</u>
	Maximum	0.946			
25mm	Minimum	<u>0.984</u>	8mm	3.3mm	<u>1.114</u>
	Maximum	0.985			

**PFEIFER INDUSTRIES, LLC.**

2180 Corporate Lane, Suite 104 ~ Naperville, IL 60563 USA

Phone (630) 596-9000 Fax (630) 596-9002

E-mail: info@pfeiferindustries.com Web site: www.pfeiferindustries.com

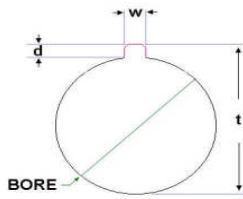

**DIN 7154, H7 Metric Bore and DIN 6885, Js9  
Square Keyway Tolerances**

		Bore (inches)	Keyway Width (w)	Keyway Height (d) Reference	(t) - DIM
28mm	<u>Minimum</u> <u>Maximum</u>	<u>1.102</u> 1.103	8mm <u>0.314</u> 0.316	3.3mm	<u>1.232</u> 1.240
30mm	<u>Minimum</u> <u>Maximum</u>	<u>1.181</u> 1.182	8mm <u>0.314</u> 0.316	3.3mm	<u>1.311</u> 1.319
32mm	<u>Minimum</u> <u>Maximum</u>	<u>1.260</u> 1.261	10mm <u>0.393</u> 0.394	3.3mm	<u>1.390</u> 1.398
35mm	<u>Minimum</u> <u>Maximum</u>	<u>1.378</u> 1.379	10mm <u>0.393</u> 0.394	3.3mm	<u>1.508</u> 1.516
38mm	<u>Minimum</u> <u>Maximum</u>	<u>1.496</u> 1.497	10mm <u>0.393</u> 0.394	3.3mm	<u>1.626</u> 1.634
40mm	<u>Minimum</u> <u>Maximum</u>	<u>1.575</u> 1.576	12mm <u>0.472</u> 0.473	3.3mm	<u>1.705</u> 1.713
42mm	<u>Minimum</u> <u>Maximum</u>	<u>1.654</u> 1.655	12mm <u>0.472</u> 0.473	3.3mm	<u>1.783</u> 1.791
45mm	<u>Minimum</u> <u>Maximum</u>	<u>1.772</u> 1.773	14mm <u>0.550</u> 0.552	3.8mm	<u>1.921</u> 1.929
48mm	<u>Minimum</u> <u>Maximum</u>	<u>1.890</u> 1.891	14mm <u>0.550</u> 0.552	3.8mm	<u>2.039</u> 2.047
50mm	<u>Minimum</u> <u>Maximum</u>	<u>1.969</u> 1.969	14mm <u>0.550</u> 0.552	3.8mm	<u>2.118</u> 2.126
52mm	<u>Minimum</u> <u>Maximum</u>	<u>2.047</u> 2.048	16mm <u>0.629</u> 0.631	4.3mm	<u>2.217</u> 2.224
55mm	<u>Minimum</u> <u>Maximum</u>	<u>2.165</u> 2.167	16mm <u>0.629</u> 0.631	4.3mm	<u>2.335</u> 2.343
58mm	<u>Minimum</u> <u>Maximum</u>	<u>2.283</u> 2.285	16mm <u>0.629</u> 0.631	4.3mm	<u>2.453</u> 2.461
60mm	<u>Minimum</u> <u>Maximum</u>	<u>2.362</u> 2.363	18mm <u>0.708</u> 0.710	4.4mm	<u>2.535</u> 2.543

**PFEIFER INDUSTRIES, LLC.**

2180 Corporate Lane, Suite 104 ~ Naperville, IL 60563 USA

Phone (630) 596-9000 Fax (630) 596-9002

E-mail: info@pfeiferindustries.com Web site: www.pfeiferindustries.com

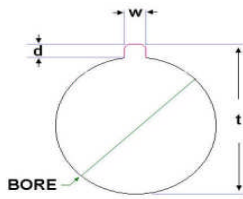

**DIN 7154, H7 Metric Bore and DIN 6885, Js9  
Square Keyway Tolerances**

		Bore (inches)	Keyway Width (w)	Keyway Height (d) Reference	(t) - DIM
62mm	<u>Minimum</u> Maximum	<u>2.441</u> 2.442	18mm <u>0.708</u> 0.710	4.4mm	<u>2.614</u> 2.622
65mm	<u>Minimum</u> Maximum	<u>2.559</u> 2.560	18mm <u>0.708</u> 0.710	4.4mm	<u>2.732</u> 2.740
68mm	<u>Minimum</u> Maximum	<u>2.677</u> 2.678	20mm <u>0.786</u> 0.788	4.9mm	<u>2.870</u> 2.878
72mm	<u>Minimum</u> Maximum	<u>2.835</u> 2.836	20mm <u>0.786</u> 0.788	4.9mm	<u>3.028</u> 3.035
75mm	<u>Minimum</u> Maximum	<u>2.953</u> 2.954	20mm <u>0.786</u> 0.788	4.9mm	<u>3.146</u> 3.154
78mm	<u>Minimum</u> Maximum	<u>3.071</u> 3.072	22mm <u>0.865</u> 0.867	5.4mm	<u>3.283</u> 3.291
80mm	<u>Minimum</u> Maximum	<u>3.150</u> 3.151	22mm <u>0.865</u> 0.867	5.4mm	<u>3.362</u> 3.370
82mm	<u>Minimum</u> Maximum	<u>3.228</u> 3.230	22mm <u>0.865</u> 0.867	5.4mm	<u>3.441</u> 3.449
85mm	<u>Minimum</u> Maximum	<u>3.346</u> 3.348	22mm <u>0.865</u> 0.867	5.4mm	<u>3.559</u> 3.567
88mm	<u>Minimum</u> Maximum	<u>3.465</u> 3.466	25mm <u>0.983</u> 0.985	5.4mm	<u>3.677</u> 3.685
90mm	<u>Minimum</u> Maximum	<u>3.543</u> 3.545	25mm <u>0.983</u> 0.985	5.4mm	<u>3.756</u> 3.764
92mm	<u>Minimum</u> Maximum	<u>3.622</u> 3.623	25mm <u>0.983</u> 0.985	5.4mm	<u>3.835</u> 3.843
95mm	<u>Minimum</u> Maximum	<u>3.740</u> 3.742	25mm <u>0.983</u> 0.985	5.4mm	<u>3.953</u> 3.961
98mm	<u>Minimum</u> Maximum	<u>3.858</u> 3.860	28mm <u>1.101</u> 1.103	6.4mm	<u>4.110</u> 4.118

**PFEIFER INDUSTRIES, LLC.**

2180 Corporate Lane, Suite 104 ~ Naperville, IL 60563 USA

Phone (630) 596-9000 Fax (630) 596-9002

E-mail: info@pfeiferindustries.com Web site: www.pfeiferindustries.com

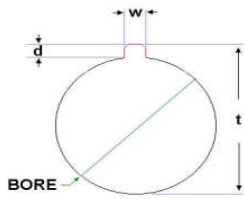

**DIN 7154, H7 Metric Bore and DIN 6885, Js9 Square Keyway Tolerances**

		Bore (inches)	Keyway Width (w)	Keyway Height (d) Reference	(t) - DIM
100mm	<u>Minimum</u> <u>Maximum</u>	<u>3.937</u> <u>3.938</u>	28mm <u>1.101</u> <u>1.103</u>	6.4mm	<u>4.189</u> <u>4.197</u>
102mm	<u>Minimum</u> <u>Maximum</u>	<u>4.016</u> <u>4.017</u>	28mm <u>1.101</u> <u>1.103</u>	6.4mm	<u>4.268</u> <u>4.276</u>
105mm	<u>Minimum</u> <u>Maximum</u>	<u>4.134</u> <u>4.135</u>	28mm <u>1.101</u> <u>1.103</u>	6.4mm	<u>4.386</u> <u>4.394</u>
108mm	<u>Minimum</u> <u>Maximum</u>	<u>4.252</u> <u>4.253</u>	28mm <u>1.101</u> <u>1.103</u>	6.4mm	<u>4.504</u> <u>4.512</u>
110mm	<u>Minimum</u> <u>Maximum</u>	<u>4.331</u> <u>4.332</u>	28mm <u>1.101</u> <u>1.103</u>	6.4mm	<u>4.583</u> <u>4.591</u>